

# Expo Concept L

The illustrations on the following pages are schematic only, not to scale, and are intended solely as a non-binding proposal of generally available net exhibition space.



# Expo Concept L | Outline



## ROOMS

- Congress Hall
- Foyer
- Conference Room 0.214
- 6 x Standard Conference Room (0.215, 0.217, 0.219, 0.221, 0.223, 0.225)



## EXHIBITION SPACE

- 307 sq. m



## RENTAL RATES

- Exhibition space: EUR 10,000.00 (50% waiver on the setup day)
- Room hires: EUR 8,240.00
- Total: EUR 18,240.00



## ADD-ONS

- Forecourt
- Bamboo Garden

# Expo Concept L | Upper Foyer

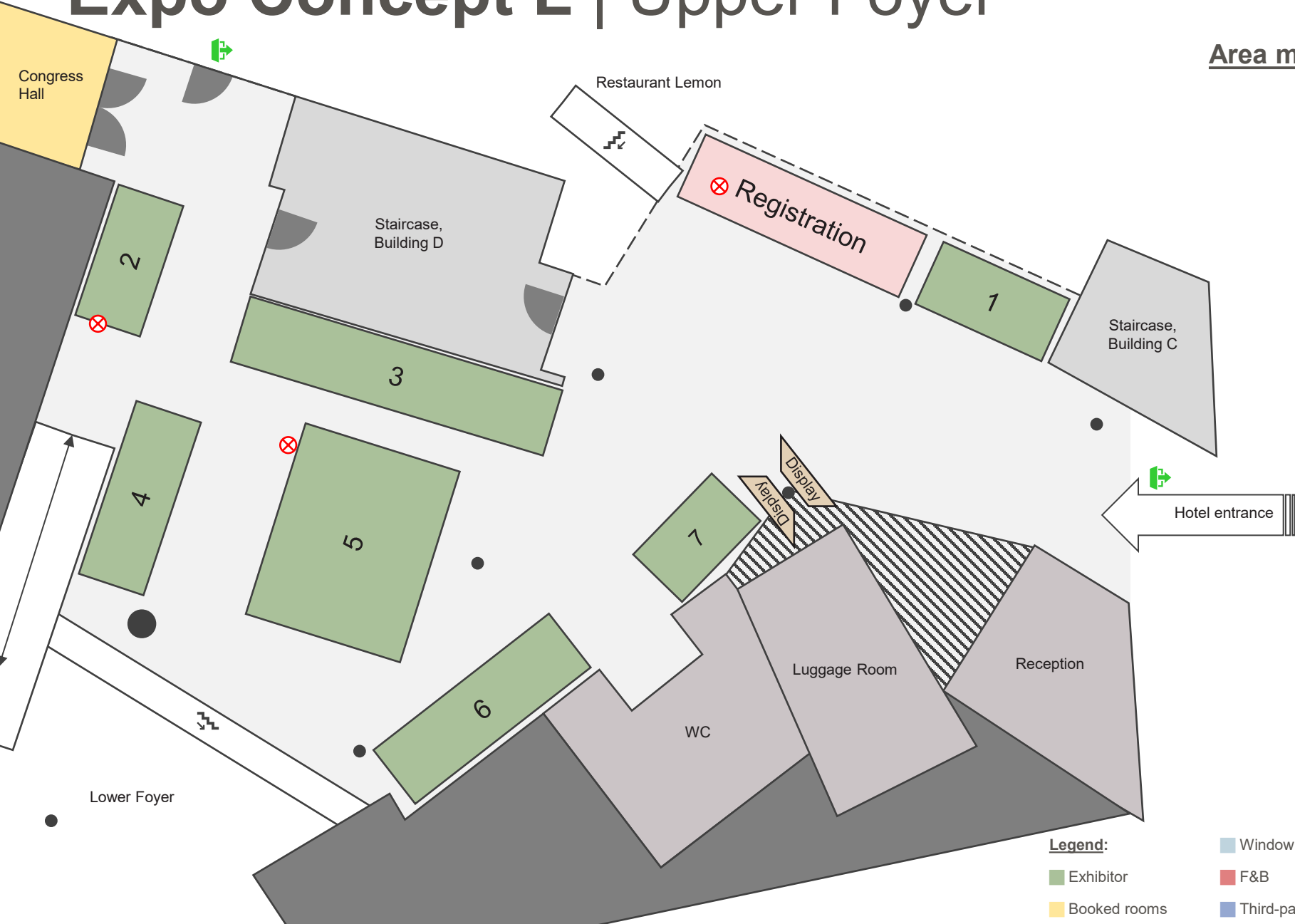

## Area measurement (sq. m) for each surface

5 sq. m (2.50m x 2.00m)	1
7 sq. m (4.00m x 2.00m)	2
21 sq. m (10.50m x 2.00m)	3
11 sq. m (5.50m x 2.00m)	4
20 sq. m (10.00m x 2.00m)	5
14 sq. m (7.00m x 2.00m)	6
6 sq. m (3.00m x 2.00m)	7

Exhibition area  $\cong$  84 sq. m

## Ceiling height

Height to lamp 2.32m  
Height to ceiling 3.21m

### Legend:

Exhibitor  
Booked rooms

Window

F&B

Third-party events

Hotel storage rooms

Room emergency exit

Column within exhibitor area

Emergency exit

Stairs

Ramp

# Expo Concept L | Lower Foyer



## Area measurement (sq. m) for each surface

6 sq. m (3.00m x 2.00m)	7
5 sq. m (2.50m x 2.00m)	8
14 sq. m (7.00m x 2.00m)	9
12 sq. m (3.00m x 2.00m)	10
7 sq. m (3.50m x 2.00m)	11
12 sq. m (6.00m x 2.00m)	12
24 sq. m (12.00 x 2.00m)	13
6 sq. m (3.00m x 2.00m)	14
6 sq. m (3.00m x 2.00m)	15
12 sq. m (3 booths, each 2.00m x 2.00m)	16
15 sq. m (7.50m x 2.00m)	17

Exhibition area  $\triangleq$  119 sq. m

## Ceiling height

Height to lamp 2.84 m  
Height to ceiling 3.72 m

### Legend:

- Exhibitor
- F&B
- Booked rooms

- Window
- Third-party events

- Hotel storage rooms
- Room emergency exit
- ⊗ Column within exhibitor area
- ➡ Emergency exit
- ↕ Stairs
- ↔ Ramp

# Expo Concept L | Shedhalle

## Area measurement (sq. m) for each surface

19	7 sq. m (3.50m x 2.00m)	23	15 sq. m (5.00m x 4.00m)	Exhibition area $\triangleq$ 104 sq. m
20	6 sq. m (3.00m x 2.00m)	24	15 sq. m (5.00m x 3.00m)	
21	16 sq. m (4.00m x 4.00m)	25	15 sq. m (5.00m x 3.00m)	<b>Ceiling height:</b> 3-6 meter
22	18 sq. m (9.00m x 2.00m)			

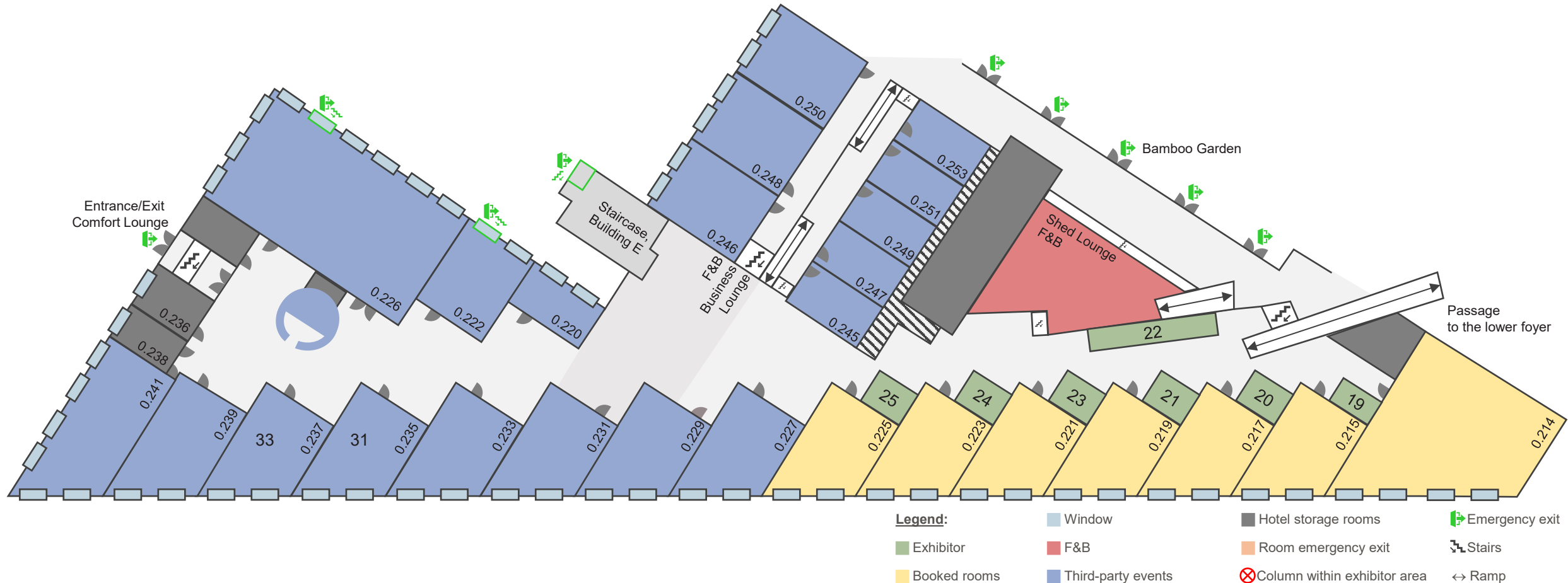

# Expo Concept L | Forecourt

## Specification

Up to 16 tonnes,  
 maximum length 10.00 m,  
 maximum height 3.85–3.95 m  
 depending on vehicle length

1

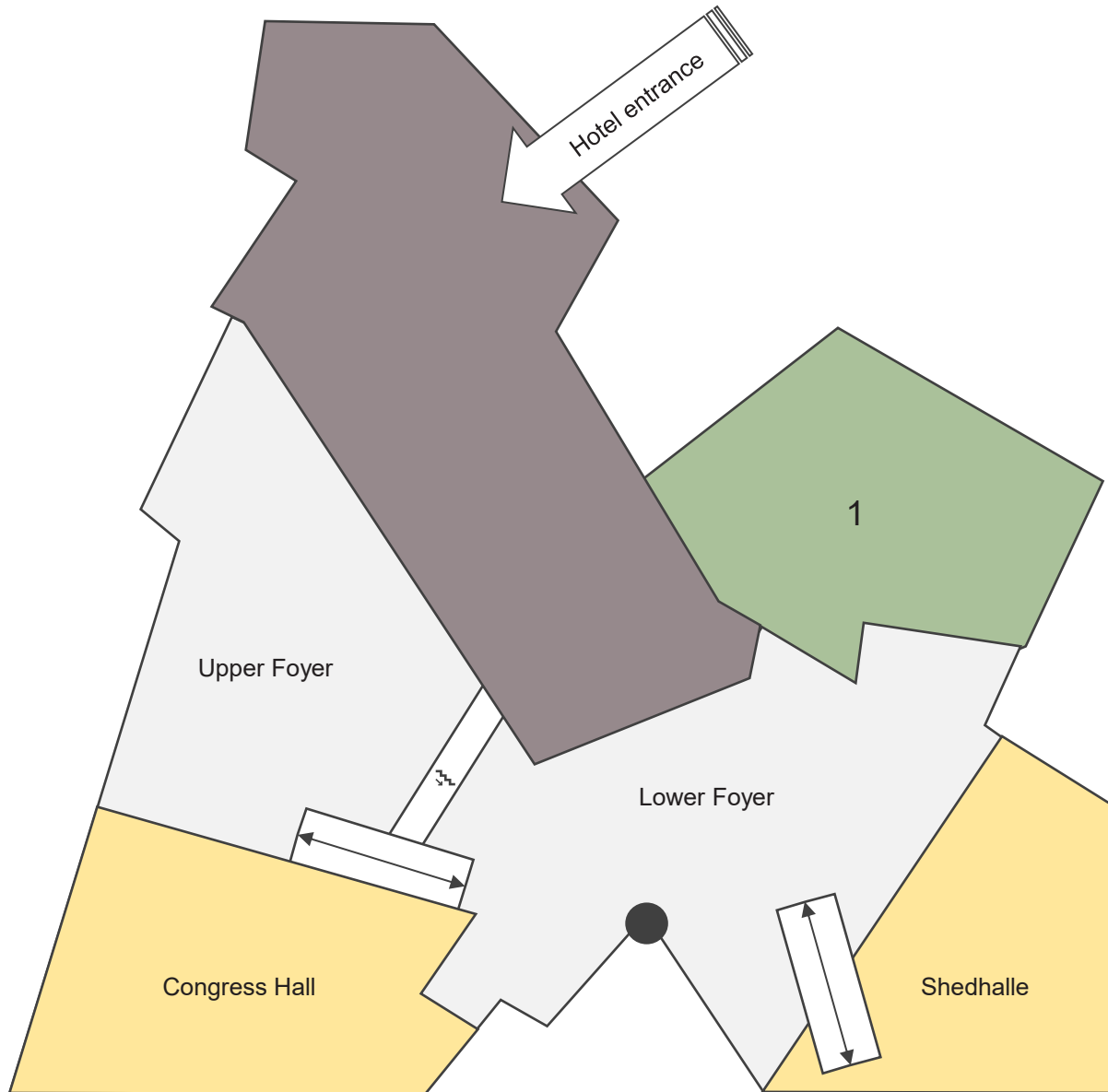

### Legend:

- Exhibitor
- Booked rooms

- Window
- F&B
- Third-party events

- Hotel storage rooms
- Room emergency exit
- Column within exhibitor area

- Emergency exit
- Stairs
- Ramp

# Expo Concept L | Bamboo Garden

## Specification

Outdoor area with terrace,  
not accessible by vehicles

1

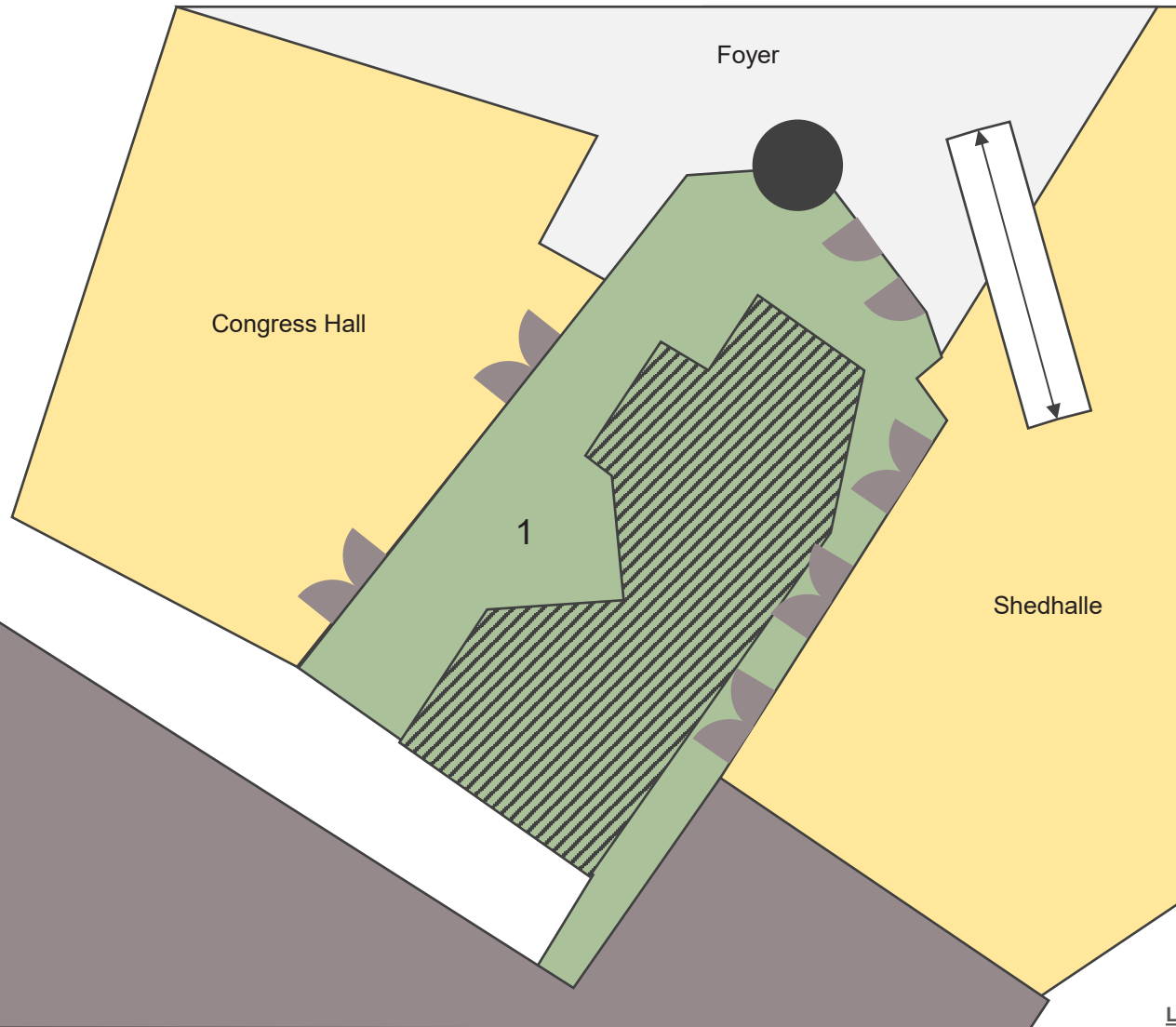

### Legend:

- Exhibitor
- Booked rooms

■ Window

■ F&B

■ Third-party events

■ Hotel storage rooms

■ Room emergency exit

⊗ Column within exhibitor area

➡ Emergency exit

 Stairs

 Ramp

# Expo Concept L | Overview



	Room	sq. m	Costs per day		max. seating capacities				
			Unit price in EUR	Subtotal in EUR	Classroom	Theatre	U-Shape	Boardroom	Circle
Messe L	Congress Hall	472	3,800.00	3,800.00	220	500	60	80	/
	Conference Room 0.214	219	1,500.00	1,500.00	90	150	40	52	/
	6 x Standard Conference Room	464	490.00	2,940.00	25-30	45-50	20	25	30
	Exhibition space	307	10,000.00	10,000.00	/				
Add-Ons	Forecourt	/	0.00 (plus power, etc.)	tba	/				
	Bamboo Garden	/	0.00 (plus power, etc.)	tba	/				
<b>Total rent: (without Add-Ons)</b>		<b>1.462</b>		<b><u>18,240.00</u> *</b>					

\*plus a minimum F&B spend of EUR 11,250.00 per day (250 participants per day; equivalent to a guaranteed spend of EUR 45.00 per person), as well as a minimum reservation of 150 rooms per night (60% of 250 rooms).

Financial year 2026 and 2027

The stated prices are gross prices (VAT as of 01/2026).

# Expo Concept | Contact



## Convention Sales Team

veranstaltung@kongresshotel-potsdam.de  
+49 331 907 7555

Am Luftschiffhafen 1  
14471 Potsdam  
[www.kongresshotel-potsdam.de](http://www.kongresshotel-potsdam.de)